

All points are coordinated relative to Irish Transverse Mercator derived from the Ordnance Survey's Virtual Reference System.

All elevations are relative to Malin Head derived from the same VRS network.

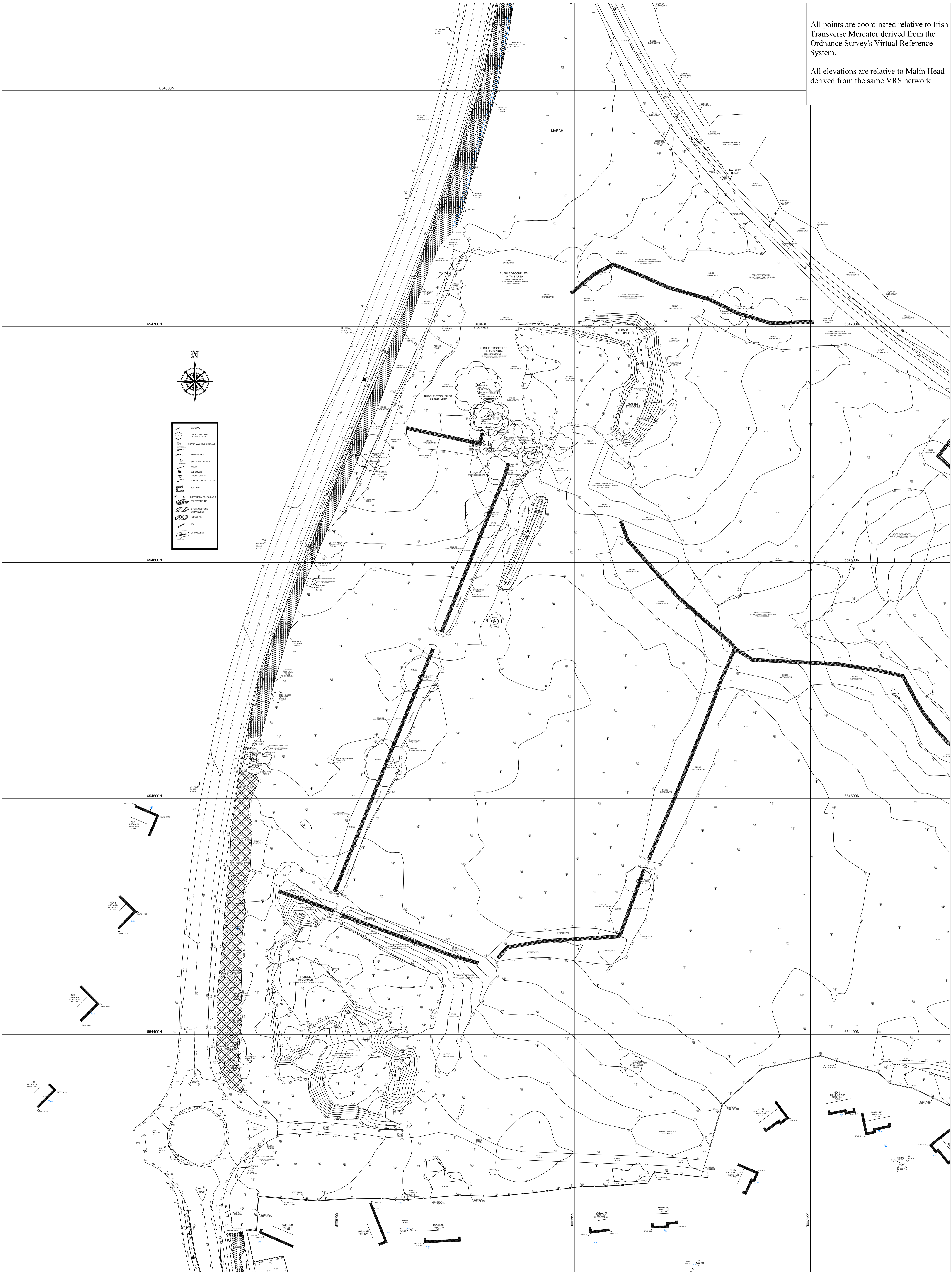

- BOUNDARY LINE (Dotted)
- BOUNDARY LINE (Dashed)
- BOUNDARY LINE (Solid)
- BOUNDARY LINE (Dash-dot)
- BOUNDARY LINE (Double)
- BOUNDARY LINE (Triple)
- BOUNDARY LINE (Hatched)
- BOUNDARY LINE (Cross-hatched)
- BOUNDARY LINE (Diagonal)
- BOUNDARY LINE (Stippled)
- BOUNDARY LINE (Wavy)
- BOUNDARY LINE (Zig-zag)
- BOUNDARY LINE (Square)
- BOUNDARY LINE (Circle)
- BOUNDARY LINE (Triangle)
- BOUNDARY LINE (Hexagon)
- BOUNDARY LINE (Octagon)
- BOUNDARY LINE (Star)
- BOUNDARY LINE (Other)



Erkina
Land & Engineering Surveyors
Info@ErkinaSurveys.ie

Drawn By: B Gibson Date: 18-11-21 Scale: 1:500 (A0)
Topographical Survey of Site at Raheen,
Limerick, County Limerick.
Client:
Drawing No. 180302-2 Rev.2